

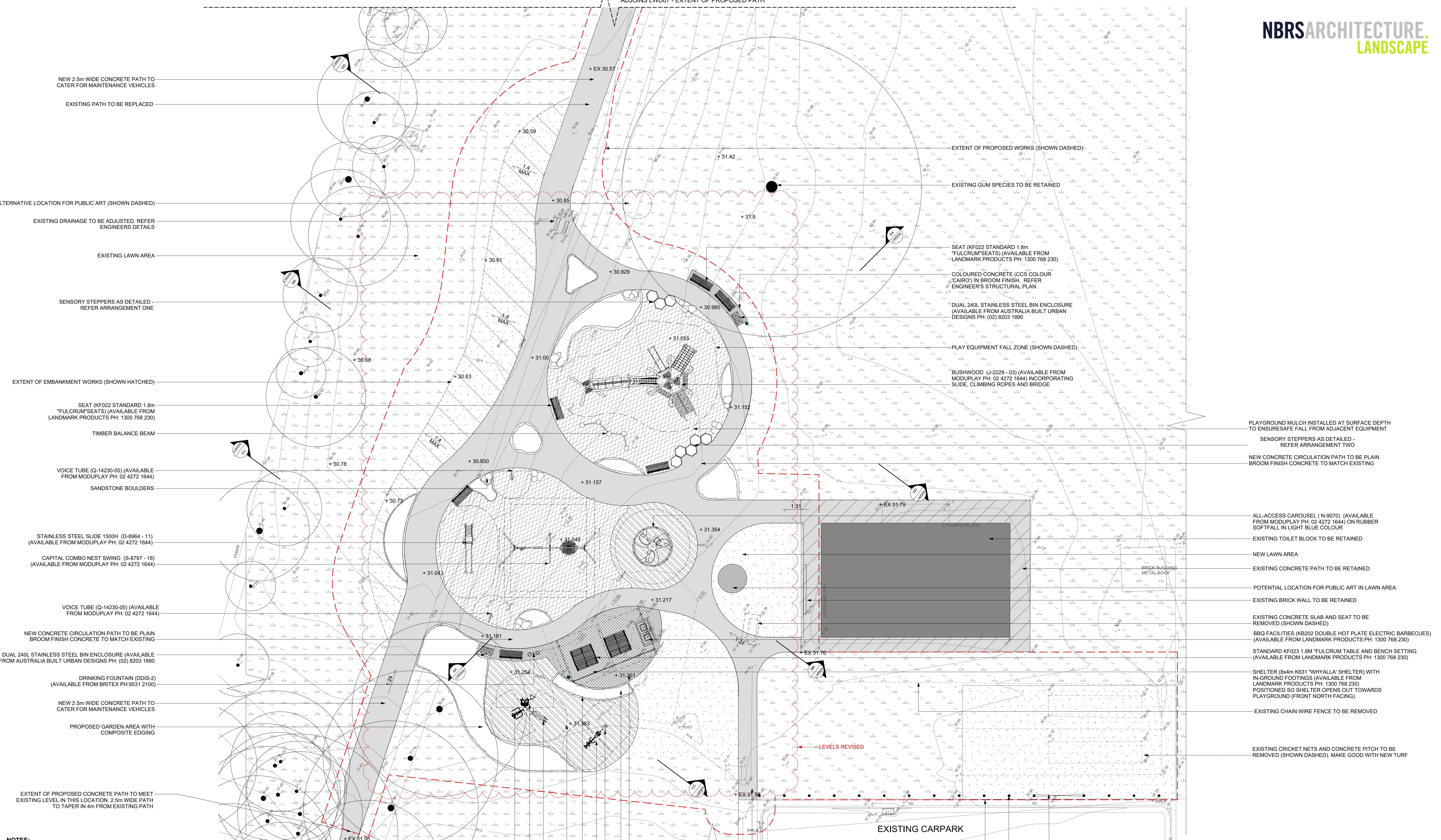

ADJOINS LWD07 - EXTENT OF PROPOSED PATH



- NOTES:**
- BUILDER TO CO-ORDINATE WITH MANUFACTURERS TO ENSURE FOOTINGS ARE CONCEALED BELOW PROPOSED CONCRETE SLABS. TO ENSURE NO FOOTING CONCRETE IS EXPOSED AT SURFACE OF FINISHED LEVELS.
  - BUILDER TO REFER TO SOIL TESTING REPORT PREPARED BY SESL AND ADHERE TO RECOMMENDATIONS AS APPLICABLE.
  - BUILDER SHALL ALLOW FOR PLAYGROUND MULCH TO BE INSTALLED TO SUITABLE DEPTH TO ENSURE SAFE FALL FROM SPECIFIC EQUIPMENT WITHIN PLAYGROUND IN COMPLIANCE WITH ALL RELEVANT AUSTRALIAN STANDARDS.
  - REFER LWD03 FOR PLANTING SCHEDULE.
  - THESE PLANS SHALL BE READ IN CONJUNCTION WITH ENGINEERS DRAWINGS.

**ISSUE**

No.	Date	Description	Chkd
1	16/02/2016	Preliminary Tender Documentation	AL
2	16/02/2016	Tender Documentation	AL
3	02/02/2016	Tender Documentation	AL
4	11/02/2016	Tender Documentation	AL
5	03/02/2016	Design Review Response	AS
6	11/02/2016	Issue to Council	AS
7	20/02/2016	Issue to Council	AS
8	20/02/2016	Issue to Council	AS

Any form of replication of this drawing in full or in part without the written permission of NBR S Architecture Pty Ltd constitutes an infringement of the copyright.  
AS/NZS 1906:2015  
Geoffrey Deane reg No. 3760, Andrew Duffin reg No. 5602, Gary Hoddinott reg No. 5286  
© 2016

**Disclaimer**  
These plans are for Client use and/or Council Approval only. Not intended for construction purpose unless specifically noted. The contractor intending to use these documents shall check and verify all works on site and report any discrepancy to the Landscape Architect prior to commencement. Failure to do so shall not be the responsibility of the Client or Landscape Architect.

**Legend**

	NEW LAWN		EXISTING LAWN		SOFT FALL		PLAYGROUND MULCH		CONCRETE PATH		PROPOSED HOSECOCK		PUBLIC ART
	GARDEN AREA		COLOURED CONCRETE		EXISTING TOILET BLOCK AND SHED		EXISTING CONCRETE PATH		RAKED LAWN AREA		LOCATION OF BIN ENCLOSURE		EXISTING TREE TO BE RETAINED

**EXTENT OF PROPOSED WORKS**  
--- EXTENT OF PROPOSED WORKS

**EXTENT OF EMBANKMENT WORKS (SHOWN HATCHED)**

**EXTENT OF PROPOSED CONCRETE PATH TO MEET EXISTING LEVEL IN THIS LOCATION. 2.5m WIDE PATH TO TAPER IN 4m FROM EXISTING PATH**

**EXTENT OF PROPOSED WORKS (SHOWN DASHED)**

**EXISTING GUM SPECIES TO BE RETAINED**

**EXISTING DRAINAGE TO BE ADJUSTED. REFER ENGINEERS DETAILS**

**EXISTING LAWN AREA**

**SEATY STEPPERS AS DETAILED - REFER ARRANGEMENT ONE**

**ALTERNATIVE LOCATION FOR PUBLIC ART (SHOWN DASHED)**

**NEW 2.5m WIDE CONCRETE PATH TO CATER FOR MAINTENANCE VEHICLES**

**EXISTING PATH TO BE REPLACED**

**SEAT (KF022 STANDARD 1.8m "FULCRUM" SEATS) (AVAILABLE FROM LANDMARK PRODUCTS PH: 1300 768 230)**

**TIMBER BALANCE BEAM**

**VOICE TUBE (Q-14230-05) (AVAILABLE FROM MODUPLAY PH: 02 4272 1644)**

**SANDSTONE BOULDERS**

**STAINLESS STEEL SLIDE 1500H (D-8064 - 11) (AVAILABLE FROM MODUPLAY PH: 02 4272 1644)**

**CAPITAL COMBO NEST SWING (S-8797 - 18) (AVAILABLE FROM MODUPLAY PH: 02 4272 1644)**

**VOICE TUBE (Q-14230-05) (AVAILABLE FROM MODUPLAY PH: 02 4272 1644)**

**NEW CONCRETE CIRCULATION PATH TO BE PLAIN BROOM FINISH CONCRETE TO MATCH EXISTING**

**DUAL 240L STAINLESS STEEL BIN ENCLOSURE (AVAILABLE FROM AUSTRALIA BUILT URBAN DESIGNS PH: (02) 8203 1890)**

**DRINKING FOUNTAIN (DDIS-2) (AVAILABLE FROM BRITEX PH:9531 2100)**

**NEW 2.5m WIDE CONCRETE PATH TO CATER FOR MAINTENANCE VEHICLES**

**PROPOSED GARDEN AREA WITH COMPOSITE EDGING**

**EXTENT OF PROPOSED CONCRETE PATH TO MEET EXISTING LEVEL IN THIS LOCATION. 2.5m WIDE PATH TO TAPER IN 4m FROM EXISTING PATH**

**SEAT (KF022 STANDARD 1.8m "FULCRUM" SEATS) (AVAILABLE FROM LANDMARK PRODUCTS PH: 1300 768 230)**

**COLOURED CONCRETE (CCS COLOUR "CAIRO") IN BROOM FINISH. REFER ENGINEER'S STRUCTURAL PLAN.**

**DUAL 240L STAINLESS STEEL BIN ENCLOSURE (AVAILABLE FROM AUSTRALIA BUILT URBAN DESIGNS PH: (02) 8203 1890)**

**PLAY EQUIPMENT FALL ZONE (SHOWN DASHED)**

**BUSHWOOD (J-2229 - 03) (AVAILABLE FROM MODUPLAY PH: 02 4272 1644) INCORPORATING SLIDE, CLIMBING ROPES AND BRIDGE**

**EXTENT OF EMBANKMENT WORKS (SHOWN HATCHED)**

**SEAT (KF022 STANDARD 1.8m "FULCRUM" SEATS) (AVAILABLE FROM LANDMARK PRODUCTS PH: 1300 768 230)**

**TIMBER BALANCE BEAM**

**VOICE TUBE (Q-14230-05) (AVAILABLE FROM MODUPLAY PH: 02 4272 1644)**

**SANDSTONE BOULDERS**

**STAINLESS STEEL SLIDE 1500H (D-8064 - 11) (AVAILABLE FROM MODUPLAY PH: 02 4272 1644)**

**CAPITAL COMBO NEST SWING (S-8797 - 18) (AVAILABLE FROM MODUPLAY PH: 02 4272 1644)**

**VOICE TUBE (Q-14230-05) (AVAILABLE FROM MODUPLAY PH: 02 4272 1644)**

**NEW CONCRETE CIRCULATION PATH TO BE PLAIN BROOM FINISH CONCRETE TO MATCH EXISTING**

**DUAL 240L STAINLESS STEEL BIN ENCLOSURE (AVAILABLE FROM AUSTRALIA BUILT URBAN DESIGNS PH: (02) 8203 1890)**

**DRINKING FOUNTAIN (DDIS-2) (AVAILABLE FROM BRITEX PH:9531 2100)**

**NEW 2.5m WIDE CONCRETE PATH TO CATER FOR MAINTENANCE VEHICLES**

**PROPOSED GARDEN AREA WITH COMPOSITE EDGING**

**EXTENT OF PROPOSED CONCRETE PATH TO MEET EXISTING LEVEL IN THIS LOCATION. 2.5m WIDE PATH TO TAPER IN 4m FROM EXISTING PATH**

**PLAYGROUND MULCH INSTALLED AT SURFACE DEPTH TO ENSURE SAFE FALL FROM ADJACENT EQUIPMENT**

**SEATY STEPPERS AS DETAILED - REFER ARRANGEMENT TWO**

**NEW CONCRETE CIRCULATION PATH TO BE PLAIN BROOM FINISH CONCRETE TO MATCH EXISTING**

**ALL-ACCESS CAROUSEL (N-9070) (AVAILABLE FROM MODUPLAY PH: 02 4272 1644) ON RUBBER SOFTFALL IN LIGHT BLUE COLOUR**

**EXISTING TOILET BLOCK TO BE RETAINED**

**NEW LAWN AREA**

**EXISTING CONCRETE PATH TO BE RETAINED**

**POTENTIAL LOCATION FOR PUBLIC ART IN LAWN AREA**

**EXISTING BRICK WALL TO BE RETAINED**

**EXISTING CONCRETE SLAB AND SEAT TO BE REMOVED (SHOWN DASHED)**

**BBO FACILITIES (KB202 DOUBLE HOT PLATE ELECTRIC BARBECUES) (AVAILABLE FROM LANDMARK PRODUCTS PH: 1300 768 230)**

**STANDARD KF023 1.8M "FULCRUM" TABLE AND BENCH SETTING (AVAILABLE FROM LANDMARK PRODUCTS PH: 1300 768 230)**

**SHELTER (6x4m K631 "HYALLA" SHELTER) WITH IN-GROUND FOOTINGS (AVAILABLE FROM LANDMARK PRODUCTS PH: 1300 768 230) POSITIONED SO SHELTER OPENS OUT TOWARDS PLAYGROUND (FRONT NORTH FACING).**

**EXISTING CHAIN WIRE FENCE TO BE REMOVED**

**EXISTING CRICKET NETS AND CONCRETE PITCH TO BE REMOVED (SHOWN DASHED). MAKE GOOD WITH NEW TURF**

**COLOUR CONCRETE (CCS COLOUR "CAIRO") 100mm THICK. REFER TO STRUCTURAL PLAN BY ENGINEERS**

**PROPOSED GARDEN AREA**

**CONCRETE PATH ACCESS TO EXISTING CARPARK**

**LEG PRESS ASSEMBLY (FFP6009) (AVAILABLE FROM A\_SPACE PH:1800 632 222)**

**AEROBIC CYCLE ASSEMBLY (FFP6018) (AVAILABLE FROM A\_SPACE PH:1800 632 222)**

**CHEST PRESS ASSEMBLY (FFP6022) (AVAILABLE FROM A\_SPACE PH:1800 632 222)**

**PULL UP LEG RAISES ASSEMBLY (FFP6019) (AVAILABLE FROM A\_SPACE PH:1800 632 222)**

**ELLIPTICAL TRAINER (FFP6027) (AVAILABLE FROM A\_SPACE PH:1800 632 222)**

**RUBBER SOFT FALL IN LIGHT BLUE COLOUR**

**EXISTING PLAY AREA AND STRUCTURE (SHOWN DASHED)**

**SLIDING RAIL FOR MAINTENANCE VEHICLE ACCESS**

**BOLLARDS AT 2m CENTRES TO RESTRICT VEHICLE ACCESS.**

**EXISTING CHAIN WIRE FENCE TO BE REMOVED**

**EXISTING CARPARK**

**EXISTING CRICKET NETS AND CONCRETE PITCH TO BE REMOVED (SHOWN DASHED). MAKE GOOD WITH NEW TURF**

**EXISTING TOILET BLOCK TO BE RETAINED**

**NEW LAWN AREA**

**EXISTING BRICK WALL TO BE RETAINED**

**EXISTING CONCRETE SLAB AND SEAT TO BE REMOVED (SHOWN DASHED)**

**BBO FACILITIES (KB202 DOUBLE HOT PLATE ELECTRIC BARBECUES) (AVAILABLE FROM LANDMARK PRODUCTS PH: 1300 768 230)**

**STANDARD KF023 1.8M "FULCRUM" TABLE AND BENCH SETTING (AVAILABLE FROM LANDMARK PRODUCTS PH: 1300 768 230)**

**SHELTER (6x4m K631 "HYALLA" SHELTER) WITH IN-GROUND FOOTINGS (AVAILABLE FROM LANDMARK PRODUCTS PH: 1300 768 230) POSITIONED SO SHELTER OPENS OUT TOWARDS PLAYGROUND (FRONT NORTH FACING).**

**EXISTING CHAIN WIRE FENCE TO BE REMOVED**

**EXISTING CRICKET NETS AND CONCRETE PITCH TO BE REMOVED (SHOWN DASHED). MAKE GOOD WITH NEW TURF**

**COLOUR CONCRETE (CCS COLOUR "CAIRO") 100mm THICK. REFER TO STRUCTURAL PLAN BY ENGINEERS**

**PROPOSED GARDEN AREA**

**CONCRETE PATH ACCESS TO EXISTING CARPARK**

**LEG PRESS ASSEMBLY (FFP6009) (AVAILABLE FROM A\_SPACE PH:1800 632 222)**

**AEROBIC CYCLE ASSEMBLY (FFP6018) (AVAILABLE FROM A\_SPACE PH:1800 632 222)**

**CHEST PRESS ASSEMBLY (FFP6022) (AVAILABLE FROM A\_SPACE PH:1800 632 222)**

**PULL UP LEG RAISES ASSEMBLY (FFP6019) (AVAILABLE FROM A\_SPACE PH:1800 632 222)**

**ELLIPTICAL TRAINER (FFP6027) (AVAILABLE FROM A\_SPACE PH:1800 632 222)**

**RUBBER SOFT FALL IN LIGHT BLUE COLOUR**

**EXISTING PLAY AREA AND STRUCTURE (SHOWN DASHED)**

**SLIDING RAIL FOR MAINTENANCE VEHICLE ACCESS**

**BOLLARDS AT 2m CENTRES TO RESTRICT VEHICLE ACCESS.**

**EXISTING CHAIN WIRE FENCE TO BE REMOVED**

**EXISTING CARPARK**

**EXISTING CRICKET NETS AND CONCRETE PITCH TO BE REMOVED (SHOWN DASHED). MAKE GOOD WITH NEW TURF**

**EXISTING TOILET BLOCK TO BE RETAINED**

**NEW LAWN AREA**

**EXISTING BRICK WALL TO BE RETAINED**

**EXISTING CONCRETE SLAB AND SEAT TO BE REMOVED (SHOWN DASHED)**

**BBO FACILITIES (KB202 DOUBLE HOT PLATE ELECTRIC BARBECUES) (AVAILABLE FROM LANDMARK PRODUCTS PH: 1300 768 230)**

**STANDARD KF023 1.8M "FULCRUM" TABLE AND BENCH SETTING (AVAILABLE FROM LANDMARK PRODUCTS PH: 1300 768 230)**

**SHELTER (6x4m K631 "HYALLA" SHELTER) WITH IN-GROUND FOOTINGS (AVAILABLE FROM LANDMARK PRODUCTS PH: 1300 768 230) POSITIONED SO SHELTER OPENS OUT TOWARDS PLAYGROUND (FRONT NORTH FACING).**

**EXISTING CHAIN WIRE FENCE TO BE REMOVED**

**EXISTING CRICKET NETS AND CONCRETE PITCH TO BE REMOVED (SHOWN DASHED). MAKE GOOD WITH NEW TURF**

**COLOUR CONCRETE (CCS COLOUR "CAIRO") 100mm THICK. REFER TO STRUCTURAL PLAN BY ENGINEERS**

**PROPOSED GARDEN AREA**

**CONCRETE PATH ACCESS TO EXISTING CARPARK**

**LEG PRESS ASSEMBLY (FFP6009) (AVAILABLE FROM A\_SPACE PH:1800 632 222)**

**AEROBIC CYCLE ASSEMBLY (FFP6018) (AVAILABLE FROM A\_SPACE PH:1800 632 222)**

**CHEST PRESS ASSEMBLY (FFP6022) (AVAILABLE FROM A\_SPACE PH:1800 632 222)**

**PULL UP LEG RAISES ASSEMBLY (FFP6019) (AVAILABLE FROM A\_SPACE PH:1800 632 222)**

**ELLIPTICAL TRAINER (FFP6027) (AVAILABLE FROM A\_SPACE PH:1800 632 222)**

**RUBBER SOFT FALL IN LIGHT BLUE COLOUR**

**EXISTING PLAY AREA AND STRUCTURE (SHOWN DASHED)**

**SLIDING RAIL FOR MAINTENANCE VEHICLE ACCESS**

**BOLLARDS AT 2m CENTRES TO RESTRICT VEHICLE ACCESS.**

**EXISTING CHAIN WIRE FENCE TO BE REMOVED**

**EXISTING CARPARK**

**EXISTING CRICKET NETS AND CONCRETE PITCH TO BE REMOVED (SHOWN DASHED). MAKE GOOD WITH NEW TURF**

**EXISTING TOILET BLOCK TO BE RETAINED**

**NEW LAWN AREA**

**EXISTING BRICK WALL TO BE RETAINED**

**EXISTING CONCRETE SLAB AND SEAT TO BE REMOVED (SHOWN DASHED)**

**BBO FACILITIES (KB202 DOUBLE HOT PLATE ELECTRIC BARBECUES) (AVAILABLE FROM LANDMARK PRODUCTS PH: 1300 768 230)**

**STANDARD KF023 1.8M "FULCRUM" TABLE AND BENCH SETTING (AVAILABLE FROM LANDMARK PRODUCTS PH: 1300 768 230)**

**SHELTER (6x4m K631 "HYALLA" SHELTER) WITH IN-GROUND FOOTINGS (AVAILABLE FROM LANDMARK PRODUCTS PH: 1300 768 230) POSITIONED SO SHELTER OPENS OUT TOWARDS PLAYGROUND (FRONT NORTH FACING).**

**EXISTING CHAIN WIRE FENCE TO BE REMOVED**

**EXISTING CRICKET NETS AND CONCRETE PITCH TO BE REMOVED (SHOWN DASHED). MAKE GOOD WITH NEW TURF**

**COLOUR CONCRETE (CCS COLOUR "CAIRO") 100mm THICK. REFER TO STRUCTURAL PLAN BY ENGINEERS**

**PROPOSED GARDEN AREA**

**CONCRETE PATH ACCESS TO EXISTING CARPARK**

**LEG PRESS ASSEMBLY (FFP6009) (AVAILABLE FROM A\_SPACE PH:1800 632 222)**

**AEROBIC CYCLE ASSEMBLY (FFP6018) (AVAILABLE FROM A\_SPACE PH:1800 632 222)**

**CHEST PRESS ASSEMBLY (FFP6022) (AVAILABLE FROM A\_SPACE PH:1800 632 222)**

**PULL UP LEG RAISES ASSEMBLY (FFP6019) (AVAILABLE FROM A\_SPACE PH:1800 632 222)**

**ELLIPTICAL TRAINER (FFP6027) (AVAILABLE FROM A\_SPACE PH:1800 632 222)**

**RUBBER SOFT FALL IN LIGHT BLUE COLOUR**

**EXISTING PLAY AREA AND STRUCTURE (SHOWN DASHED)**

**SLIDING RAIL FOR MAINTENANCE VEHICLE ACCESS**

**BOLLARDS AT 2m CENTRES TO RESTRICT VEHICLE ACCESS.**

**EXISTING CHAIN WIRE FENCE TO BE REMOVED**

**EXISTING CARPARK**

**EXISTING CRICKET NETS AND CONCRETE PITCH TO BE REMOVED (SHOWN DASHED). MAKE GOOD WITH NEW TURF**

**EXISTING TOILET BLOCK TO BE RETAINED**

**NEW LAWN AREA**

**EXISTING BRICK WALL TO BE RETAINED**

**EXISTING CONCRETE SLAB AND SEAT TO BE REMOVED (SHOWN DASHED)**

**BBO FACILITIES (KB202 DOUBLE HOT PLATE ELECTRIC BARBECUES) (AVAILABLE FROM LANDMARK PRODUCTS PH: 1300 768 230)**

**STANDARD KF023 1.8M "FULCRUM" TABLE AND BENCH SETTING (AVAILABLE FROM LANDMARK PRODUCTS PH: 1300 768 230)**

**SHELTER (6x4m K631 "HYALLA" SHELTER) WITH IN-GROUND FOOTINGS (AVAILABLE FROM LANDMARK PRODUCTS PH: 1300 768 230) POSITIONED SO SHELTER OPENS OUT TOWARDS PLAYGROUND (FRONT NORTH FACING).**

**EXISTING CHAIN WIRE FENCE TO BE REMOVED**

**EXISTING CRICKET NETS AND CONCRETE PITCH TO BE REMOVED (SHOWN DASHED). MAKE GOOD WITH NEW TURF**

**COLOUR CONCRETE (CCS COLOUR "CAIRO") 100mm THICK. REFER TO STRUCTURAL PLAN BY ENGINEERS**

**PROPOSED GARDEN AREA**

**CONCRETE PATH ACCESS TO EXISTING CARPARK**

**LEG PRESS ASSEMBLY (FFP6009) (AVAILABLE FROM A\_SPACE PH:1800 632 222)**

**AEROBIC CYCLE ASSEMBLY (FFP6018) (AVAILABLE FROM A\_SPACE PH:1800 632 222)**

**CHEST PRESS ASSEMBLY (FFP6022) (AVAILABLE FROM A\_SPACE PH:1800 632 222)**

**PULL UP LEG RAISES ASSEMBLY (FFP6019) (AVAILABLE FROM A\_SPACE PH:1800 632 222)**

**ELLIPTICAL TRAINER (FFP6027) (AVAILABLE FROM A\_SPACE PH:1800 632 222)**

**RUBBER SOFT FALL IN LIGHT BLUE COLOUR**

**EXISTING PLAY AREA AND STRUCTURE (SHOWN DASHED)**

**SLIDING RAIL FOR MAINTENANCE VEHICLE ACCESS**

**BOLLARDS AT 2m CENTRES TO RESTRICT VEHICLE ACCESS.**

**EXISTING CHAIN WIRE FENCE TO BE REMOVED**

**EXISTING CARPARK**

**EXISTING CRICKET NETS AND CONCRETE PITCH TO BE REMOVED (SHOWN DASHED). MAKE GOOD WITH NEW TURF**

**EXISTING TOILET BLOCK TO BE RETAINED**